

2XKSR10 COLLECTOR ASSEMBLY INSTRUCTIONS

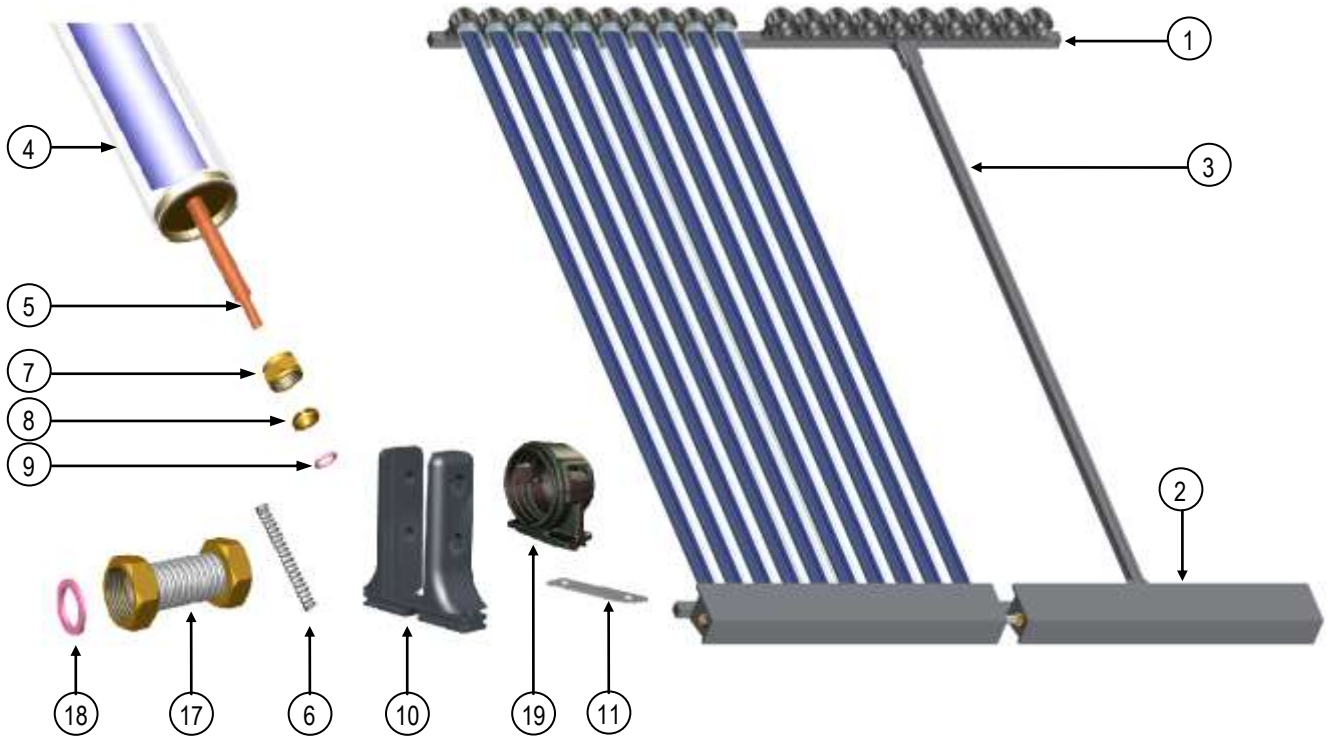

Preparation of the vacuum tube to be encased in the KSR10 solar collector

Stage 1



Stage 2

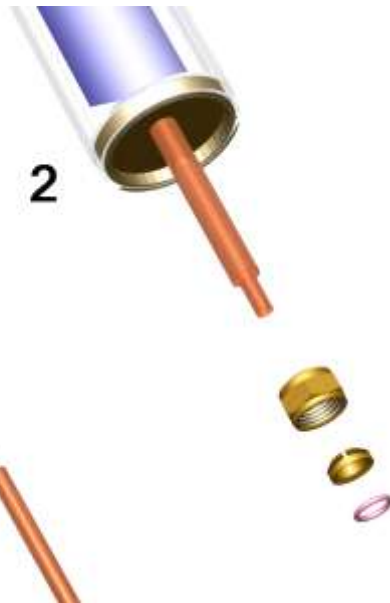

No	Name	Mount
1	Top panel	2
2	Bottom panel	2
3	Vertical bar	2
4	Vacuum tube	20
5	Cooper tube Ø6 x1980	20
6	Spring	20
7	Clamp connector nut 3/8"	20
8	Shrink disc	20
9	Silicone O-ring (red)	20
10	Connector	4
11	Insert	4
12	Screw M6x40	8
13	Nut M6	8
14	Screw M8x16	8
15	Washer Ø8	8
16	Nut M8	8
17	Pipe union KS 3/4"	1
18	Gasket S 24/18	2
19	Holder / clip	20
20	Pressure screw M6	4

1. Insert a spring and a cooper pipe Ø6 mm into each vacuum tube supplied.
2. Next, on the ending of the Ø10 mm vacuum pipe, place the elements of the connector clamp, in the order and position as shown in the picture.

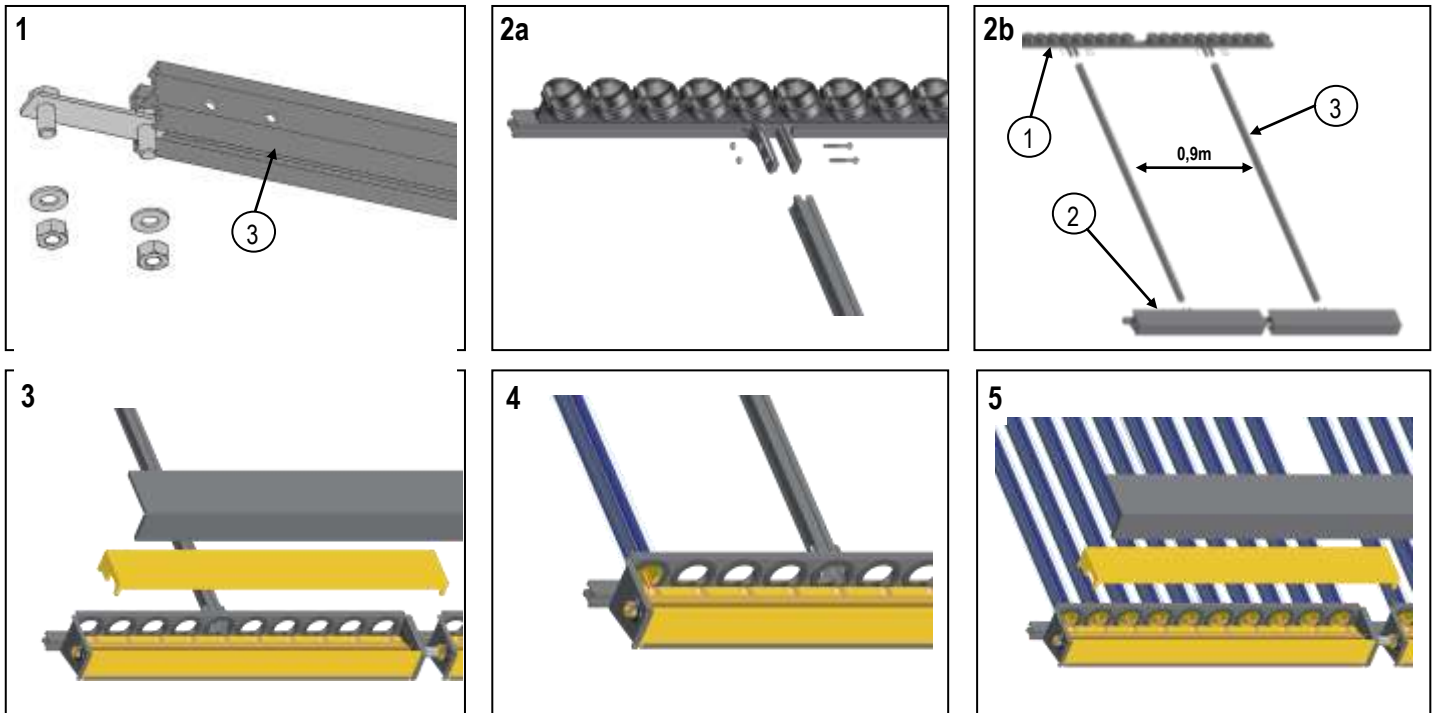

Steps of assembly:

1. Slide two inserts (11) together with screws (14) into the vertical bars (3).
2. To the bars of top panels (1) and the bars of bottom panels (2) insert connectors AL (10). Attach the top panels (1) and the bottom panels (2) to the vertical bars (3) with the use screws (12) and nuts (13). Slide the holders (19) into the top bar. Block the side brackets using the pressure screws (20). The spacing between the vertical bars (3) for vacuum collectors should be about 0,9 m.
3. Remove the covers from the bottom panels (2) with insulation.
4. Insert a spring (6) and a copper tube of \varnothing 6mm (5) into every vacuum tube (4).
5. After checking the installation's air-tightness put the insulation and covers of the bottom panels (2) back on. Close all evacuated tube's holders with clips (19).

ATTENTION!!!

The smooth operation of the installation is dependent on its thorough venting, which can be achieved by using the appropriate vortex pump. It is recommended to use a vortex pump with discharge head of 20m and capacity of 2,5m³/h.